

CryOmega®

Multi-Use Disposable Cryosurgical Device



NEW!
-89°C

Effective - Delivers a continuous, direct spray of nitrous oxide (-89°C) to treatment site. With a lower operating temperature compared to canister-based systems, CryOmega® provides clinically effective freezing with pinpoint precision.

Convenient - Simple, hassle-free operation. Activate internal cartridge once and the device is ready for use. No need for additional accessories or replacement cartridges. Up to 300 seconds treatment time per device.

Economical - Low-cost, effective cryosurgery in any clinical setting.

Disposable - Simply dispose of the entire unit when the internal cartridge is empty.

CryOmega®

The new COLD standard

Multi-Use Disposable Cryosurgical Device

NEW!
-89°C



**NEW! Easier cartridge
activation system**



**NEW! 50% lighter
push button**

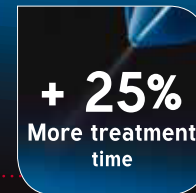

+ 25%
More treatment
time

**Up to 25% more treatments
(total 300 seconds)**

**Clinically effective direct application
of liquid nitrous oxide (-89°C) in
a convenient and economical device**

 **CryoConcepts**
THE CRYO EXPERTS

 **Manufacturer:**
CryoConcepts LP
205 Webster Street
Bethlehem, PA 18015, USA
www.cryoconcepts.com

 **Emergo Europe**
Prinsessegracht 20
2514 AP The Hague
The Netherlands

 0543

CryOmega® is a registered trademark of CryoConcepts LP.
US Patent # 8,647,337. International patents pending.

CryOmega®

Multi-Use Disposable Cryosurgical Device

"I believe the CryOmega® device is appropriate for all Primary Care Physicians. It's a great way to introduce cryosurgery for physicians who don't realize how important full-time cryosurgery is for their practice."

John E. Hocutt, Jr. M.D., FAAFP

It's as easy as...

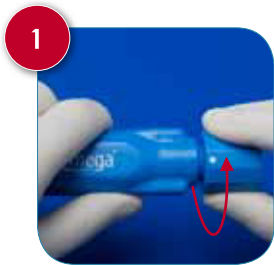

1. While holding the CryOmega® device with one hand, firmly grab the knob at the end of the unit with the other hand. Firmly turn the knob clockwise one full rotation, making sure that the white dot on the knob aligns with the arrow on the device. The unit is now ready for use.



2. Make sure that the white dot on the knob aligns with the arrow on the device. **Important: do not turn the knob back. The unit is now under pressure.**



3. Hold the CryOmega® device vertically, tip down, and position the spray nozzle directly over the lesion at a 1 cm distance. Then press the actuator and spray cryogen directly onto the lesion moving the spray in a small circle to cover the area.

Treatment of Verruca Vulgaris with one 8 second treatment

Before treatment



Immediately after treatment



16 days after treatment



Although not exhaustive, the table below contains suggested freezing times as reported in the literature. These are wide ranges and provide only a guideline for consideration.

Type of Lesion	Literature freeze time range	Reference number *
Verruca Vulgaris	10-20 sec.	3,4,5
Verruca Plantaris	10-20 sec.	4
Molluscum Contagiosum	3-10 sec.	4,6
Skin Tags	5-10 sec.	3,4
Lentigo	2-5 sec.	3,4,5
Actinic Keratosis	5 sec.	3,4
Verruca Plana	5-15 sec.	4,5
Seborrheic Keratosis	5-10 sec.	4
Genital Lesions	5-12 sec.	4

References

1. Rubinsky, Boris, CryoSurgery, Annual Review Biomedical Engineering, 02:157-187, 2000.
2. Gage, Andrew, What Temperature is Lethal for Cells? J Dermatol Surg Oncol, 5-6, 1979.
3. Andrews, Mark, CryoSurgery for Common Skin Conditions, American Family Physician, 69:10, 2365-2372, 2004.
4. Dawber, Rodney, Colver, Graham, et.al., Cutaneous Cryosurgery: Principles and Clinical Practice, Martin Dunitz Publisher, 2cd Edition, 1997.
5. Strumia, Renata, La Crioterapia in Dermatologia, Published by Business Enterprise SRL, 2006.
6. Dockery, Gary, Treating A Child With Multiple, Mildly Pruritic Papules, Podiatry Today, 20:4, 2007.